

# Flash Stamp Machine T1511M

## User Manual

110V



**trodat**<sup>®</sup>  
CREATING ORIGINALS

TRODAT USA, INC.  
2600 Greenleaf Avenue  
Elk Grove Village, IL 60007  
United States

**IMPORTANT NOTICE**

Trodat USA cannot be held responsible for any direct or indirect damages which result from using or working with the machine described herein. Only staff trained by Trodat USA personnel should operate this machine. Before use, the manual should be read and followed carefully. Furthermore, Trodat reserves the right to change or alter any product described herein without prior notice.

# Trodat Flash Machine T1511M

## User Manual

### Content

I.	Important safety information.....	4
II.	Scope of use.....	6
III.	Delivery content and installation.....	7
IV.	Controls and functions.....	8
V.	Required additional equipment.....	11
VI.	Operation.....	13
VII.	Cleaning.....	19
VIII.	Technical specification.....	19

**Warning:** Read manual and on-product label before installing or using this product. Failure to follow safety precautions could result in serious injury.

Keep manual near machine for future reference. In case of problems or further questions, please contact your Trodat sales representative.

## I. Important safety information

Before installing or operating the T1511M Flash Machine and periodically during use, read this user manual carefully and follow all safety precautions. Serious injury to the operator and damage to the machine can result from failure to follow these precautions. All maintenance or repairs are only to be done by trained Trodat personnel. Contact your Trodat sales representatives for maintenance like changing the lamps or the glass plate or with any other questions. Keep this manual near the machine for future reference.

***Warning:*** Do not open machine lid after you press the start button and the green light is on. Doing so exposes your eyes to intense light which can cause injury. In addition, do not look at the lid after pressing the start button since a small amount of intense light can be visible when the lamps flash.

### **Electrical hazards**

- Machine contains very high and hazardous voltages from capacitors. Always unplug the machine for a minimum of 1 hour from the power supply prior to installation or cleaning.
- Do not disassemble or repair the machine, replace the lamps or remove the glass plate. Electrical repairs should only be done by trained Trodat personnel.
- Never modify or bypass any of the safety features. Doing so could result in serious injury due to an electric shock or unintentional exposure to extreme light.
- Do not use the machine with non-grounded power sources. Operate the machine only with a power source that meets the specifications indicated on the label at the back of the machine.
- Do not use wall sockets, extension cords or surge protectors with other electrical devices as this can result in overloading and a risk of fire or electrical shock.
- Power cords should be routed so that they are not likely to be walked on or pinched by items placed against them.
- If the power cord shows any damage or material fatigue, do not use the machine. Unplug power immediately.
- Do not use machine if it is or becomes damaged. Unplug power immediately.
- Do not dispose of the machine with domestic waste. Electronic devices have to be disposed of according to the regional directives on electronic and electric waste disposal.

### Location of machine

- The machine may only be operated on a stable, level and clean work surface.
- Use only indoors and in dry areas.
- Do not operate it in explosive environments.
- Locate away from heat sources or equipment that may generate excessive vibration, dust or moisture.
- To prevent condensation inside the machine, avoid locations where there could be sudden temperature changes.
- Serious injury to the operator and damage to the machine can result from poor machine placement.

### General

- Do not use any accessories or supplies (spacers, glass plates, vellum papers, transparency sheets etc.) that are not recommended or supplied by Trodat, as this may cause hazards.
- Always unplug the machine after you finish using it.

**Below is a copy of the warning label that is attached to this machine. Read and follow the safety precautions. If this label is missing or illegible, contact Trodat for a free replacement.**

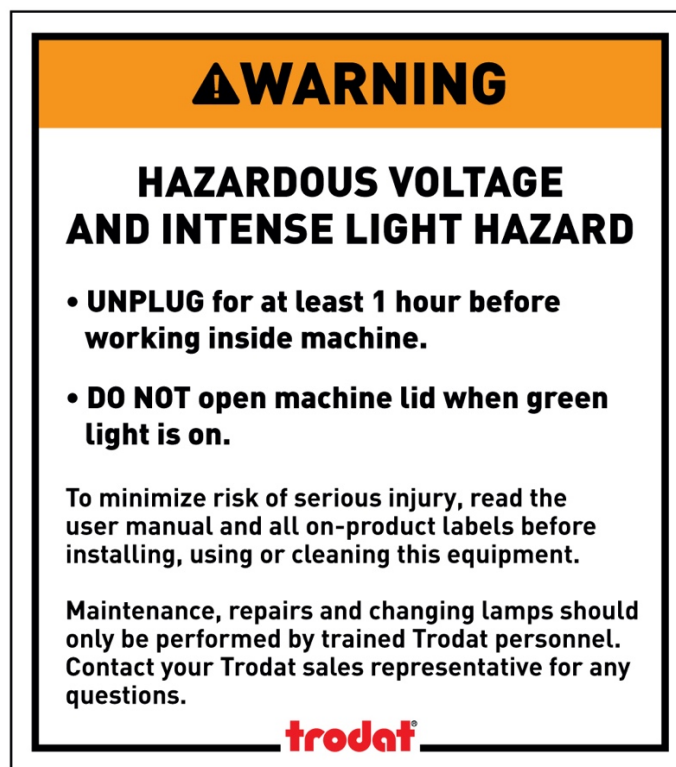

*Warning label*

## II. Scope of use

The Flash Machine T1511M is an exposure system, designed to quickly and easily expose (flash) all models and sizes of Trodat's Premium Flash range including the new (die box) and regular (foam) systems:

- MaxLight (S-Style, Z-Style)
- PSI (E-Style)
- Slim Stamp (E-Style)
- Super Slim (Slim Style)



The Flash Machine T1511M supports all production methods of the Premium Flash range, no matter if (a) an entire die box or (b) foam only (microporous photosensitive text plate) is exposed (explanation see below). After placing the printed vellum paper and a clear transparency film in the machine, the die box or foam can be positioned and the machine closed. The desired energy level will charge the system and properly expose the die box or foam. The exposed die box or foam is then ready for inking and assembling in the proper MaxLight, PSI or Slim Stamp pre-inked stamp.

### (a) DIE BOX (new system)

Combines foam and dry cartridge all in one. The die box is exposed on the grey foam side and is inked by filling ink into the ink cartridge cavities.

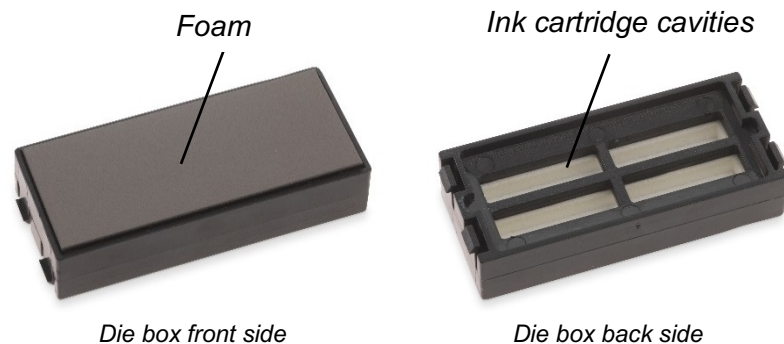

### (b) FOAM (regular system)

The foam only text plate has foam on the one side and a thin cartridge layer on the other side for fast ink migration. The foam is exposed on the grey foam side and is assembled in a retainer ring or die box for inking.

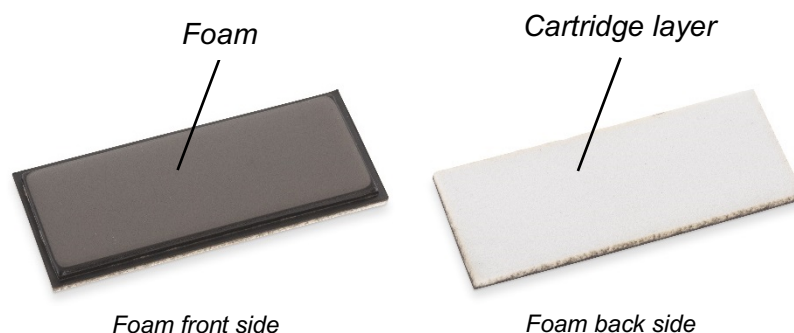

### III. Delivery content and installation

Please check the packaging to be sure you have all of the contents and that there was no damage during shipping. In case of any damage contact your supplier immediately and do not use the Flash Machine.

#### Delivery content

- Flash Machine T1511M
- Spacer (pressure plate)
- Power cable
- User manual

#### Installation

Place the Flash Machine on a stable, even and clean surface and make sure that it is placed in an unobstructed area to ensure that the cooling fan can operate properly. Use the supplied power cable to connect the machine to a grounded power outlet.

**Warning:** Do not remove or replace glass plate. High voltage inside the machine may cause serious injury. Contact a Trodat sales representative for help with the glass plate or lamps.



Power connection

## IV. Controls and functions

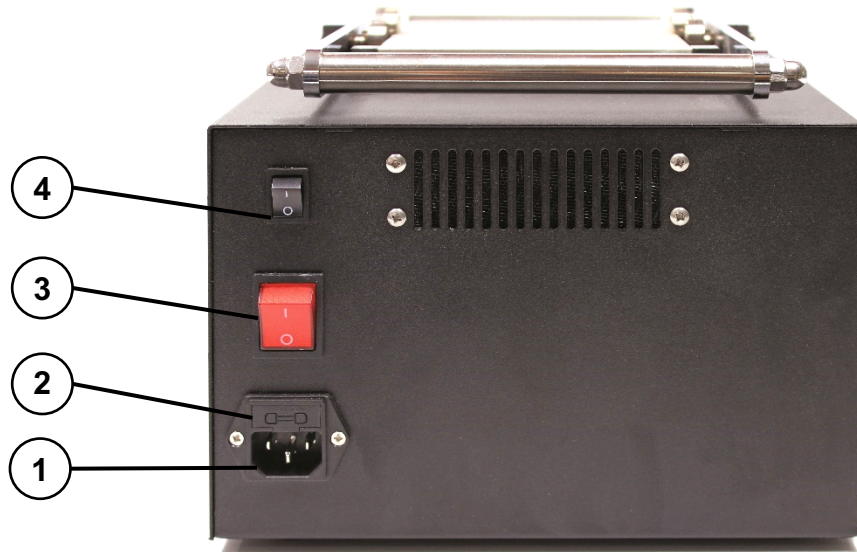

*Machine back side*

### 1 Power plug

The power plug is located on the back of the Flash Machine. It allows the use of grounded power cables only.

### 2 Fuse

The fuse holder is located above the power plug. This contains the fuse that provides overload protection for the Flash Machine.

### 3 Power switch

The power switch is located on the back of the Flash Machine. Press this switch to turn the power on/off. The switch will be lighted when the machine is turned on. The light will go off when the machine is turned off.

### 4 Cooling switch

The cooling switch is located on the back of the Flash Machine. Press this switch to turn the cooling fan on/off. The cooling fan is for cooling the electronic device, lamps and glass. If the glass gets to warm, this will have a negative impact on your exposure result (fine fonts not readable anymore). Due to the integrated cooling fan, a more efficient production process is possible, as less cooling phases are required. It is recommended that you turn on the cooling fan when the temperature rises above 95°F (35°C), to cool down the exposure system which will help to achieve optimal exposure results.



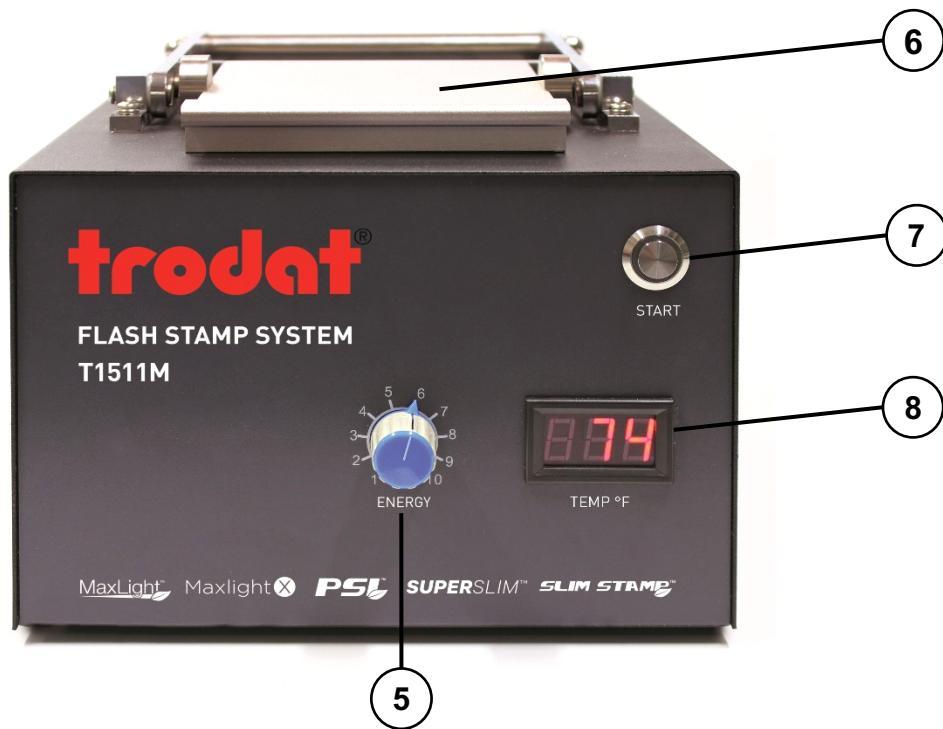

Machine front side

## 5 Energy dial

The energy dial sets the energy level of the lamps when the exposure is activated. The energy levels are numbered "1-10", with "1" being the lowest and "10" being the highest setting. For exposing all Trodat Premium Flash models it is recommended that you set the energy level at "6".

## 6 Cover and clamping mechanism

The clamping mechanism of the cover is for the compression of the die box or foam. The cover evenly applies pressure and compresses the die box or foam, which is required for proper exposure results. For safety purposes the exposure process will not start if the cover is in the open position.

## 7 Start button (Flash button)

The start button is located on the front of the Flash Machine. Press the button to execute an exposure. This button is only active if the clamping mechanism is in the fully closed and locked position.

**Warning:** Do not open machine lid after you press the start button and the green light is on. Doing so exposes your eyes to intense light which can cause injury. In addition, do not look at the lid after pressing the start button since a small amount of intense light can be visible when the lamps flash.

## 8 Temperature indicator

The temperature indicator is located on the front of the Flash Machine and indicates the temperature of the exposure system in degrees Fahrenheit. The temperature of the machine will increase during a continuous production process. Operating the machine over a temperature of 122°F (50°C) can have a negative impact on the exposure result and can lead to an overexposure (overflashing) of the foam. It is recommended that you turn on the cooling fan when the temperature rises above 95°F (35°C), to cool down the exposure system and help achieve optimal exposure results.

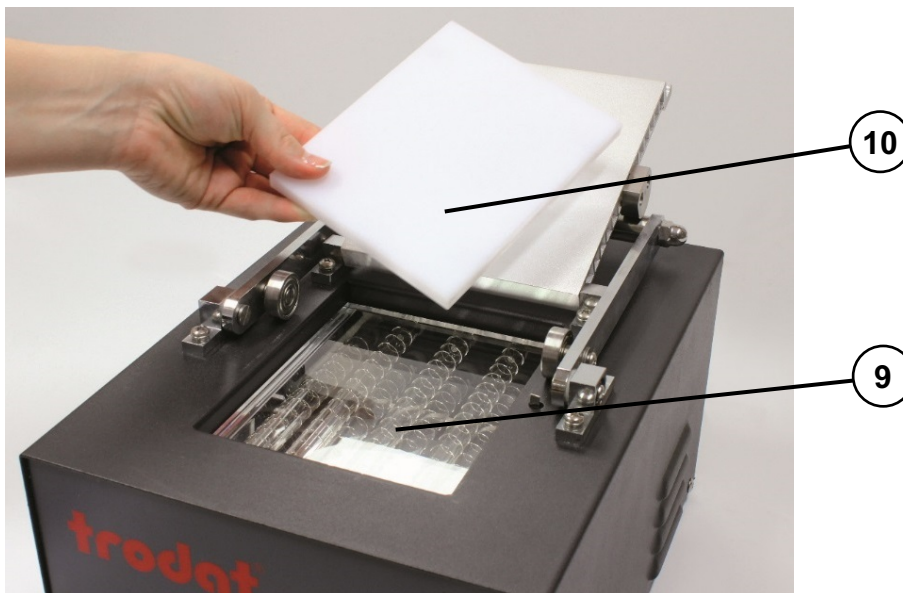

Machine open

## 9 Exposure area

The exposure area of the machine (5-29/32" x 4-11/32" = 150mm x 110mm) is designed to expose all MaxLight, PSI, Slim Stamp and Super Slim sizes.

***Important:*** Always make sure that the exposure area is clean before flashing.

## 10 Spacer (pressure plate)

The spacer is mounted on the cover with magnets for easy removal. For exposing foam, only the delivered spacer must be mounted on the cover. For exposing entire die boxes, the spacer must not be mounted on the cover.

***Important:*** Never expose a die box, while the spacer is mounted on the cover. This can cause serious damage to the machine.

## V. Required additional equipment

For proper stamp production with the Flash Machine T1511M, the following additional equipment is needed:

### 1 Computer with graphic arts software

A computer with basic graphic arts software (e.g. Corel Draw) is recommended for typesetting. A regular word processing software can also be used for typesetting, but you will be unable to use the recommended Trodat typesetting templates.

**Please note:** Trodat offers typesetting templates for all MaxLight, PSI, Slim Stamp and Super Slim models and sizes as Corel Draw files. Each typesetting template consists of 3 attributes: model number, black positioning frame (outer border) and red typesetting frame (inner border) – see picture "Typesetting template". The model number is located next to the positioning frame of each individual template. The black positioning frame represents the total overall size of the die box or foam and is used for centering the die box or foam over the printed artwork. The red typesetting frame represents the maximal area for typesetting. Before printing make sure to delete the red typesetting frame, otherwise it will be visible on the stamp text plate.

Please contact your Trodat sales representative to get the typesetting templates.

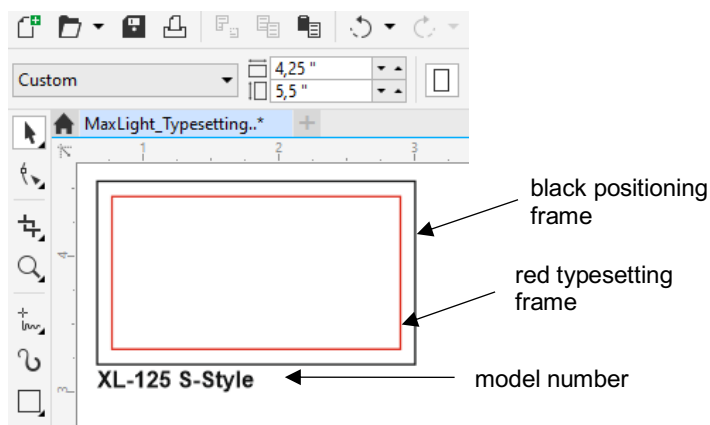

Typesetting template

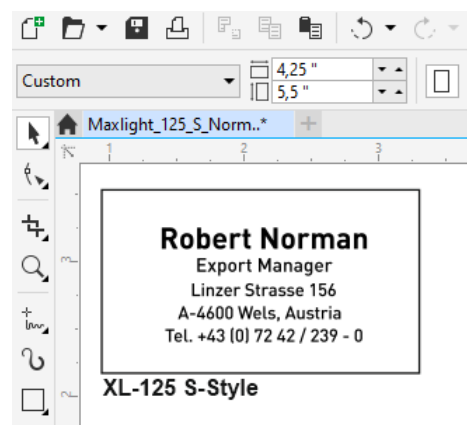

Sample artwork

### 2 Monochrome laser printer

A monochrome (only black and white) laser printer with 600 DPI (dots per inch) or higher resolution is required for printing an artwork on vellum paper. Do not use a color laser or ink jet printer for vellum printing. Using the improper printer will cause unsatisfactory stamp impression quality. The density of the toner is important to block the light of the print areas. You may need to adjust the print density setting of your printer for optimal performance. See your printer's owner manual.

Please also make sure you are only using genuine toner cartridges from the printer manufacturer for best printing results.

### **3 Trodat Premium Vellum Paper**

The vellum paper is used for printing the desired artwork. It is available in two sizes: pre-cut (4-1/4" x 5-1/2" = 108mm x 140mm) or US letter (8-1/2" x 11" = 216mm x 279mm). The pre-cut size perfectly fits into the T1511M Flash Machine (no extra cutting needed before putting into the machine). It is highly recommended that you use only the Trodat Premium Vellum paper. Using improper vellum can cause bad exposure results and lead to unsatisfactory stamp impression quality.

### **4 Trodat Premium Transparency Film**

The clear transparency film is placed on top of the printed vellum to separate the artwork from the Flash foam. It is available in two sizes: pre-cut (4-1/4" x 5-1/2" = 108mm x 140mm) or US letter (8-1/2" x 11" = 216mm x 279mm). The pre-cut size perfectly fits into the T1511M Flash Machine (no extra cutting needed before putting into the machine). Please use only the Trodat Premium Transparency Film for proper production results.

## VI. Operation

Do not use any accessories or supplies (spacers, glass plates, vellum papers, transparency sheets etc.) that are not recommended or supplied by Trodat, as this may cause hazards.

All Trodat's Premium Flash models use a high-quality flash foam as text plates. The foam will be sealed during the exposure process according to the artwork.

### 1 Print artwork

The artwork for the exposure process should be printed using a 600 dots per inch (DPI) or higher monochrome laser printer on Trodat Premium Vellum Paper. The vellum can be printed from both sides. The print should be right-reading (positive) and not reversed or mirrored for use in the T1511M Flash Machine. For proper exposure results, the printed artwork has to be deep black. Make sure to not use grey or color tones in your artwork. Set the print density in the printer properties to its highest setting and use the printer setting "Print black only". Do not print in greyscale, this will have a negative impact on the exposure result.

The artwork for the stamp should be surrounded by a black printable positioning frame that is the same overall size as the die box or foam that will be exposed. Doing this will allow for easy placement of the die box or foam during the loading process. For fast and easy artwork designing you can use Trodat's typesetting templates (described in the previous chapter), which offer positioning frames for all MaxLight, PSI, Slim Stamp and Super Slim models and sizes.

**Tip:** When printing several artworks on one vellum sheet, make sure to leave at least a 1/2" gap between each artwork in your layout. This is to allow for quick and easy placement of the die box or foam.



Printed vellum

### 2 Switch on machine

Switch the machine on using the main power switch on the back side of the machine.



Switch on machine



### 3 Open cover and adapt machine setup

Open the cover of the machine and make sure that you have the correct machine setup depending on whether a (a) die box or (b) foam only will be exposed:

**(a) Exposing Die Boxes:** For exposing entire die boxes, remove the spacer from the cover. Following models have to be exposed without spacer:

- MaxLight S-Style
- PSI E-Style
- Slim Stamp E-Style
- Super Slim

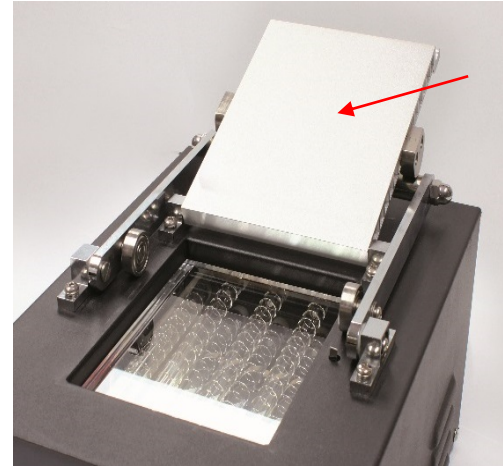

(a) Setup for die box – no spacer on cover

**(b) Exposing Foam:** For exposing foam only, place the spacer onto the cover (magnets center it automatically).

Following models have to be exposed with the spacer:

- MaxLight Z-Style\*

\*XL-800 cannot be flashed as assembled die box. Always disassemble the XL-800 die box and flash foam only.

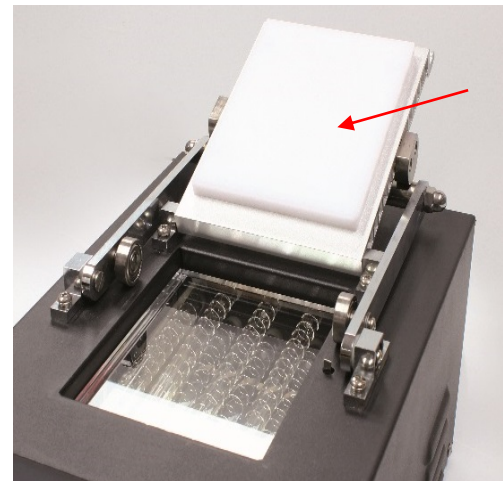

(b) Setup for foam – spacer on cover

### 4 Place vellum

Make sure that the exposure area is clean and place the printed vellum paper onto the glass. The vellum is placed with the toner side facing up and the copy right reading (not reversed or mirrored). Ensure that the vellum paper is larger than the exposing die box or foam.

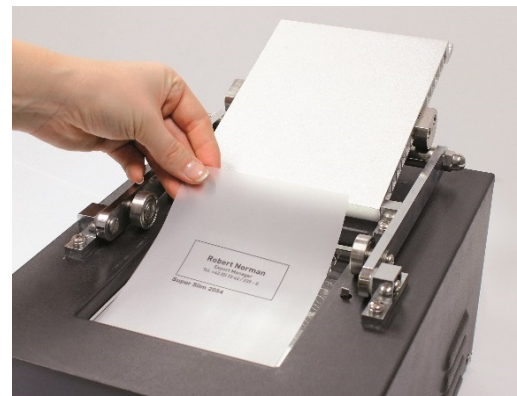

Place vellum

### 5 Place transparency film

Place one sheet of transparency film on top of the printed vellum. Ensure that the transparency sheet fully covers the vellum paper. The clear transparency film can be used from both sides. It is necessary to prevent the toner (from the printed vellum) from being deposited on the die box or foam due to the pressure and heat generated during the exposure process.

**Tip:** For easier handling you can staple the vellum and transparency together and then place it on the glass. This will prevent the vellum and transparency from sliding when you proceed to the next step.



Place transparency

### 6 Place die box or foam

Take the appropriately sized die box or foam for your printed artwork. Make sure that the transparency film as well as the die box or foam is clean and dust free. If necessary, you can clean it with a dry cloth. Place the (a) die box or (b) foam (grey foam side facing down) on top of the transparency using the positing frame of the artwork. Make sure that the (a) die box or (b) foam is positioned exactly within the positing frame. You can also expose multiple die boxes or foams during one exposure process.

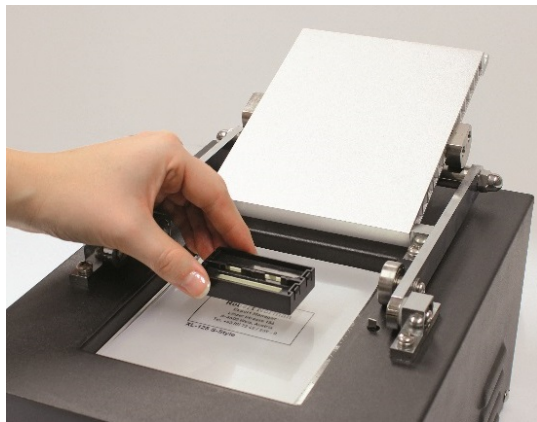

(a) Place die box



(b) Place foam

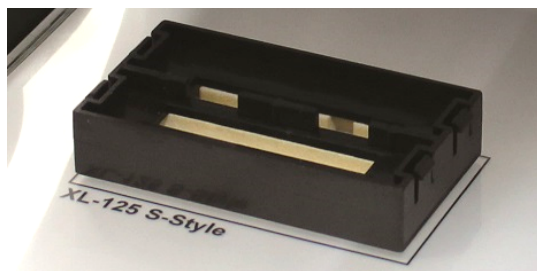

(a) Die box within positioning frame



(b) Foam within positioning frame

**Please note:** Super Slim stamps do not use an extra die box or foam. Super Slims have the foam and ink cartridge already included in the stamp and are exposed like die boxes. Just remove the dust cover (do not remove the index window) and place the complete stamp (grey foam side facing down) on the transparency film.

## 7 Close cover and clamping mechanism

Lower the cover, grasp the handle and push it into an upright position until the handle meets with resistance and feels locked.

**Important:** Do not over push handle past the point where it feels locked.



Close cover and clamping mechanism

## 8 Set energy and press start

Switch on the machine using the main switch on the back side. Set the energy dial to the recommended energy level of "6" and press the start button one time. A green light goes on and after a few seconds, the machine will flash once. The die box or foam is fully exposed after one flash cycle. There is no need to flash a second time.



Set energy at "6" and press start

**Warning:** Do not open machine lid after you press the start button and the green light is on. Doing so exposes your eyes to intense light which can cause injury. In addition, do not look at the lid after pressing the start button since a small amount of intense light can be visible when the lamps flash.

**Please note:** Both die box and foam only use the identical flash foam material so there is no need to change the recommended energy level of "6" between components. However, for artwork layouts with very fine details, the energy level can be modified accordingly, if the impression quality is not as desired. To reach an even finer impression, increase the energy level appropriately (e.g. "8") and possibly expose two times. After the first exposure, press the start button again. Do not open the lid between the first and second exposure cycle. With these exposure settings, very thin lines and fine details will print even more crisply.



## 9 Remove transparency

Open the clamp cover and take out the die box or foam. Remove the transparency from the exposed (a) die box or (b) foam.



(a) Remove transparency from die box



(b) Remove transparency from foam

**Please note:** Exposing without transparency film is not possible. The printed vellum and transparency film can only be used for one exposure (no reuse possible).

## 10 Ink and assemble the stamp

The exposed (a) die box or (b) foam is now ready to be used in the corresponding MaxLight, PSI or Slim Stamp mount.



(a) Exposed die box ready for inking



(b) Exposed foam ready for inking and assembly



**For training or instructions on proper production, assembly, and inking instructions, contact your Trodat Sales Representative.**

**HOW TO ASSEMBLE AND INK MAXLIGHT & PSI FLASH STAMPS**

**MAXLIGHT "Z" STYLE**

1. Place flashed "Z" foam into trim ring (impression facing down).
2. Remove center of dry "Z" cartridge.
3. Place "Z" cartridge on top of "Z" foam and inside the trim ring.
4. Select type and color of ink. Fill ink cavity above the top of the dry "Z" cartridge, creating a heaping effect.
5. Wait 30 seconds to 1½ minutes (30 seconds for Forever Ink and 1½ minutes for Premium Ink), then replace center of "Z" cartridge into ink cavity. Do not apply any downward pressure on center piece as this will cause ink to leak out of the unit.
6. Center cartridge helps store excess ink.
7. Once all ink has absorbed into foam and cartridge, snap trim ring into place inside mount.
8. Be sure trim ring is snapped in on all sides. "Z" foam migrates in approximately 30-60 minutes (30 minutes for Forever Ink and 60 minutes for Premium Ink).

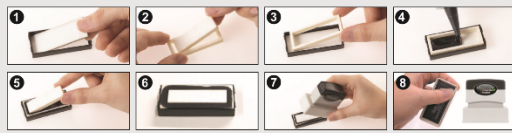

**PSI "Z" STYLE**

1. Slide the back door open past the ink cavity of the dry "Z" cartridge. Do not remove the back door from the die box.
2. Select type and color of ink. Fill cavity above the top of the dry "Z" cartridge, creating a heaping effect.
3. Let the ink recede below the top of the dry "Z" cartridge.
4. Slide the back door into position.
5. Make sure the back door is fully closed.
6. Slide the die box into the stamp mount.
7. Let the ink settle at least 5 minutes before turning the stamp upside down.
8. Stamp is ready to use.

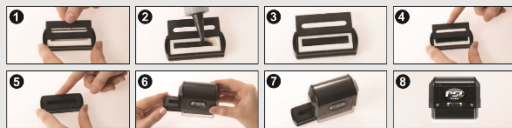

**INUED**

remove the slide out back door from the mount. Mount with the flashed side down. XL42 pocket mount. Level surface with the handles open on each side. (not recommended for the XL42 pocket mounts). Push door back onto the stamp.



dry "Z" cartridge, creating a heaping effect. 1½ minutes for Premium Ink), then downward pressure on center piece as

into place inside mount. approximately 30-60 minutes



*Inking instructions*

## VII. Cleaning

The Trodat Flash Machine T1511M has been designed for low maintenance operation as well as ease of use. There are regularly scheduled cleaning requirements consisting of cleaning the glass plate and machine body as needed. Please observe the following cleaning tips.

**Warning:** *Unplug the unit for a minimum of 10 minutes to cool down the glass before doing any of the following cleaning.*

### **Cleaning the exposure glass plate and outside machine body**

It is very important to keep the surface of the glass in the exposure area clean and dust free. This will prevent any possibility of foreign objects interfering with producing a properly exposed die box or foam.

Please do not clean the machine with any household cleaners. The glass plate should only be cleaned with a dry microfiber cleaning cloth but not with any fluids in general. The same applies for cleaning the machine body.

## VIII. Technical specification

**Flash Stamp Machine Model:** T1511M

**Quantity of lamps:** 3

**Exposure area:** 5-29/32" x 4-11/32" (150mm x 110mm)

**Dimensions:** 13-3/8" x 9-1/4" x 7-5/8" (340mm x 235mm x 194mm)

**Weight:** 22.2lbs (10.1kg)

**AC power supply:** 110-120 V

**Frequency:** 50/60 Hz

**Power consumption:** 1200 W